

NUCLEI DI FERRITE PER SALDATURA AD ALTA FREQUENZA

FERRITE CORES FOR HIGH FREQUENCY WELDING

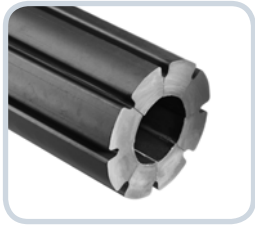

ZRSH TYPE

Standard shape, dimension and tolerance

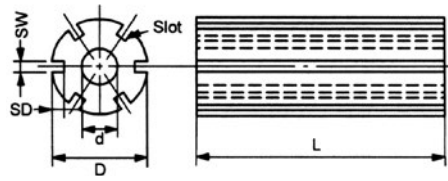

Product identification

IP1 Zrsh 10 x 200 x 3
(1) (2) (3) (4) (5)

- (1) Material name
- (2) Type
- (3) Outer diameter (mm)
- (4) Length (mm)
- (5) Inner diameter (mm)

Part No. (D x L x d)	Tolerance D d		Number of slots	Slot depth. SD	Slot depth. SW	Structure
ZRSH 6 x 200 x 3	±0.35	±0.30	6	Dx0.15	Dx0.08	One piece
ZRSH 7 x 200 x 3	±0.35	±0.30	6	Dx0.15	Dx0.08	One piece
ZRSH 8 x 200 x 3	±0.25	±0.20	6	Dx0.15	Dx0.08	One piece
ZRSH 8 x 200 x 5	±0.30	±0.20	6	Dx0.15	Dx0.08	One piece
ZRSH 9 x 200 x 3	±0.30	±0.20	6	Dx0.15	Dx0.06	One piece
ZRSH 9 x 200 x 5	±0.30	CS	6	Dx0.15	Dx0.06	One piece
ZRSH 10 x 200 x 3	±0.30	CS	6	Dx0.15	Dx0.08	One piece
ZRSH 10 x 200 x 5	±0.30	±0.25	6	Dx0.15	Dx0.08	One piece
ZRSH 11 x 200 x 3	±0.35	CS	8	Dx0.15	Dx0.08	One piece
ZRSH 11 x 200 x 5	±0.35	CS	8	Dx0.15	Dx0.08	One piece
ZRSH 12 x 200 x 3	±0.35	CS	8	Dx0.15	Dx0.06	One piece
ZRSH 13 x 200 x 5	±0.40	CS	8	Dx0.15	Dx0.06	One piece
ZRSH 13 x 200 x 7	±0.40	CS	8	Dx0.15	Dx0.06	One piece
ZRSH 14 x 200 x 5	±0.40	CS	8	Dx0.15	Dx0.06	One piece
ZRSH 15 x 200 x 5	±0.45	CS	8	Dx0.15	Dx0.05	One piece
ZRSH 15 x 200 x 7	±0.45	±0.25	8	Dx0.15	Dx0.06	One piece
ZRSH 16 x 200 x 5	±0.50	CS	8	Dx0.15	Dx0.05	One piece
ZRSH 16 x 200 x 8	±0.50	±0.25	8	Dx0.15	Dx0.06	One piece
ZRSH 17 x 200 x 5	±0.50	CS	8	Dx0.15	Dx0.05	One piece
ZRSH 18 x 200 x 5	±0.55	CS	8	Dx0.15	Dx0.05	One piece
ZRSH 18 x 200 x 8	±0.55	±0.25	8	Dx0.15	Dx0.05	One piece
ZRSH 19 x 200 x 6	±0.55	CS	8	Dx0.15	Dx0.05	One piece
ZRSH 19 x 200 x 9	±0.55	CS	8	Dx0.15	Dx0.05	One piece
ZRSH 20 x 200 x 6	±0.60	CS	8	Dx0.15	Dx0.05	One piece
ZRSH 20 x 200 x 10	±0.60	CS	8	Dx0.15	Dx0.05	One piece
ZRSH 21 x 200 x 6	±0.60	CS	8	Dx0.15	Dx0.04	One piece
ZRSH 22 x 200 x 6	±0.65	CS	8	Dx0.15	Dx0.04	One piece
ZRSH 23 x 200 x 6	±0.70	CS	8	Dx0.15	Dx0.04	One piece
ZRSH 23 x 200 x 11	±0.70	CS	8	Dx0.15	Dx0.04	One piece
ZRSH 24 x 200 x 12	±0.70	CS	8	3,75 mm	1,25 mm	One piece
ZRSH 25 x 200 x 12	±0.70	CS	8	3,75 mm	1,25 mm	One piece
ZRSH 26 x 200 x 13	±0.70	±0.35	8	3,75 mm	1,25 mm	One piece
ZRSH 27 x 200 x 6	±0.70	±0.35	8	4,05 mm	1,35 mm	One piece
ZRSH 27 x 200 x 8	±0.70	±0.35	8	4,05 mm	1,35 mm	One piece
ZRSH 27 x 200 x 13	±0.70	±0.35	8	4,05 mm	1,35 mm	One piece
ZRSH 28 x 200 x 14	±0.80	±0.40	8	4,05 mm	1,8 mm	One piece
ZRSH 29 x 200 x 14	±0.80	±0.40	8	4,05 mm	1,8 mm	One piece
ZRSH 30 x 200 x 15	±0.80	±0.50	8	4,05 mm	3,00 mm	One piece
ZRSH 32 x 200 x 16	±0.80	±0.50	8	4,05 mm	3,00 mm	One piece
ZRSH 34 x 200 x 17	±0.80	±0.50	8	4,05 mm	3,00 mm	One piece
ZRSH 36 x 200 x 18	±0.90	±0.50	8	4,05 mm	3,00 mm	One piece
ZRSH 38 x 200 x 19	±1.15	±0.50	8	4,05 mm	3,00 mm	8 pieces
ZRSH 40 x 200 x 20	±1.20	±0.80	8	5,00 mm	3,00 mm	8 pieces
ZRSH 42 x 200 x 21	±1.20	±0.80	8	5,50 mm	3,5 mm	8 pieces
ZRSH 44 x 200 x 22	±1.50	±0.80	8	6,00 mm	3,5 mm	8 pieces
ZRSH 46 x 200 x 23	±1.50	±0.80	8	6,00 mm	3,5 mm	8 pieces
ZRSH 48 x 200 x 24	±1.50	±0.80	8	6,00 mm	4,0 mm	8 pieces
ZRSH 55 x 200 x 27	±1.50	±0.80	8	6,00 mm	4,0 mm	8 pieces
ZRSH 60 x 200 x 30	±1.50	±0.80	8	6,00 mm	4,0 mm	8 pieces
ZRSH 65 x 200 x 32	±1.70	±0.80	8	6,00 mm	4,0 mm	8 pieces
ZRSH 73 x 200 x 35	±2.00	±0.80	8	6,00 mm	4,0 mm	8 pieces
ZRSH 80 x 200 x 40	±2.00	±0.80	8	6,00 mm	4,0 mm	8 pieces
ZRSH 95 x 200 x 48	±2.00	±0.80	8	6,00 mm	4,0 mm	8 pieces